

Sullivan Palatek®

**NEW
C-Series**



10 Horsepower

Introducing Sullivan-Palatek's **NEW** C-Series Compressor Modules
C-ing is believing! Owning is worry free!

Perfectly designed to fit where you need it and fulfill all your
compressed air requirements.

Features:

- Energy efficient
- Quiet - 68dba
- 230/460 volt, 3 phase
- Microprocessor control
- Multi point measuring and protection of pressure and temperature
- E-Stop
- RS-485 communication interface function
- Seven function maintenance schedule/monitoring
- Full function electrical control for motor protection
 - Motor overload relay
 - Phase protection

Dedicated to Quality & Committed to Support

MICROPROCESSOR FEATURES



Displays:

- Run time
- Load time
- Oil filter change time
- Separator change time
- Oil change time
- High temperature alarm
- Overload alarm
- RS 485 Communication

NUMBER	DESCRIPTION
1	Motor
2	Motor Sheave
3	V-Belts
4	Encapsulated Air End
5	Discharge Hose
6	Oil Hose
7	Compressor Sheave
8	Intake Valve Assembly
9	Air Filter Assembly
10	Fan with Motor
11	Oil and Air Cooler
12	Pressure Sensor

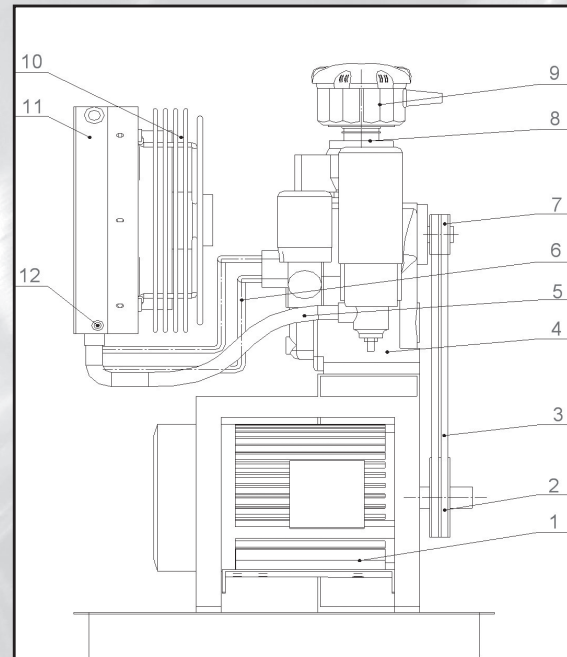

TECHNICAL DATA

CAPACITY AND PRESSURE	100 psi (6.9 bar)	40 cfm (1.1 m ³ /min)
	125 psi (8.6 bar)	35 cfm (1.0 m ³ /min)
	145 psi (10 bar)	30 cfm (8 m ³ /min)
Sump Capacity		.5 gallons (1.89 L)
Discharge NPT		1/2 inch
RPM (Motor) TEFC		3510
Length		25 inches (630 mm)
Width		25 inches (630 mm)
Height		45 inches (1030 mm)
Weight		465 pounds (211 kg)

Distributed by

**Sullivan
Palatek**

1201 W. US Highway 20 Tel: 219-874-2497
Michigan City, IN 46360 Tel: 800-438-6203
www.sullivanpalatek.com Email: info@palatek.com

